

Desenho de espaços exteriores

Objetivo:

As qualidades arquitetônicas estão presentes no espaço exterior

Quando isso acontece, o espaço exterior passa a ser um lugar exterior

Assim, lugares e ações humanas que ocorrem neles são uma coisa só, e vinculam os objetos e fenômenos ao ser humano que os percebem.

Os lugares possuem:

Componentes topológicos do lugar

- **Centralidade(1)**,
- **Direções horizontais e verticais (3,4)**,
- **Fechamento (5)**,
- **Área Interna(2)**,
- **Entradas/transições(6)**.

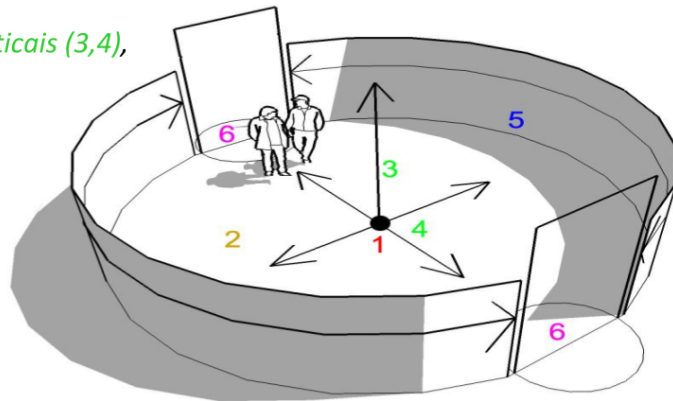

As Qualidades

- **Territorialidade:** Processo no qual uma área (terrestre, espacial ou aquática) é mantida com o propósito de preservar e proteger uma pessoa ou um grupo;
- **Privacidade:** controle dos processos advindos de eventos interpessoais;
- **Identidade:** qualidades gerais que fazem com que as pessoas sintam-se ao mesmo tempo únicas e capazes de compartilhar valores da vida social.
- **Ambiência:** transforma o lugar num interior confortável, saudável.

Mas como trabalhar os componentes topológicos dos espaços exteriores para que se transformem em lugares? Quando esses componentes permitem que as pessoas atribuam e ancoragem em suas características as qualidades que são SUBJETIVAS, mas que são essenciais para os lugares.

PERCEPÇÃO

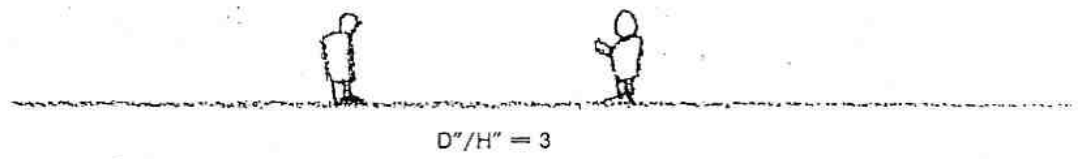
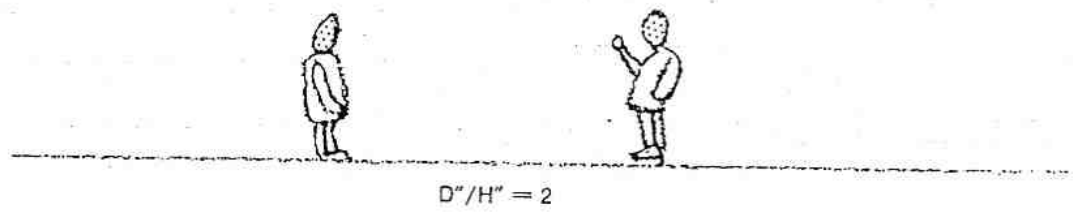
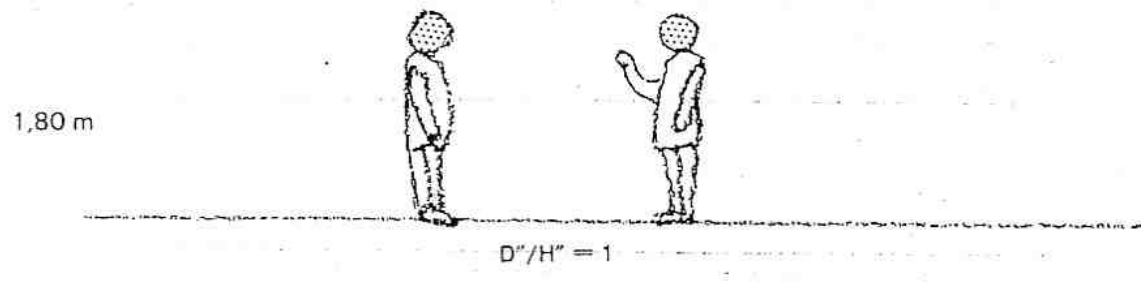
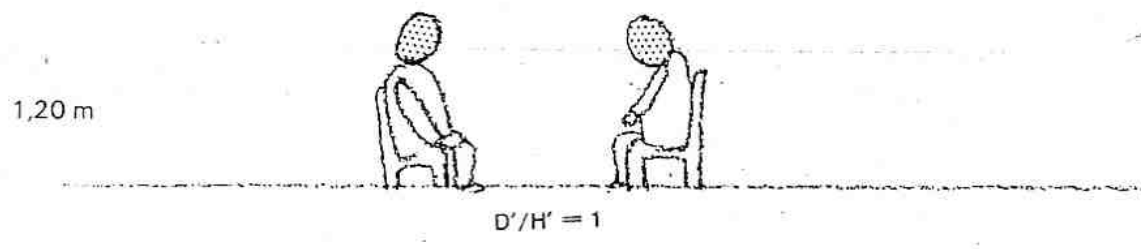
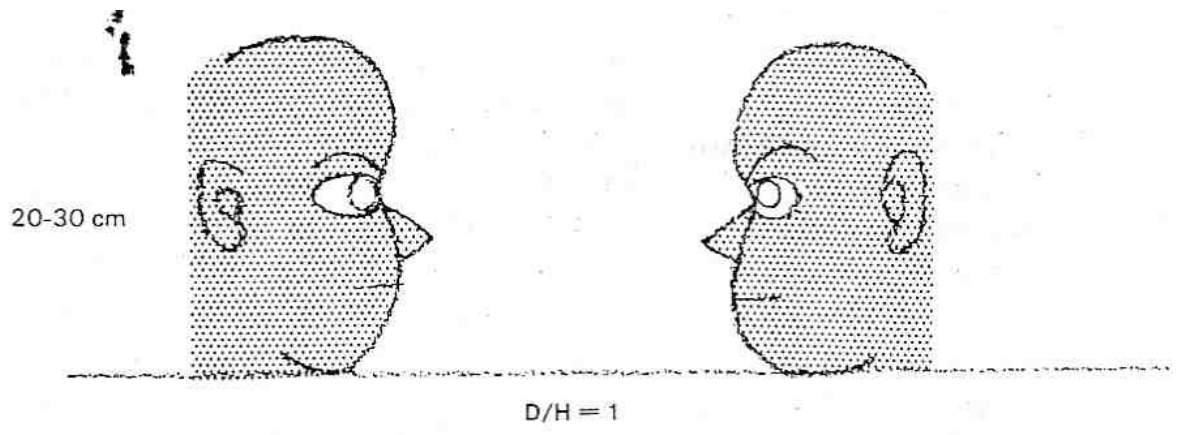

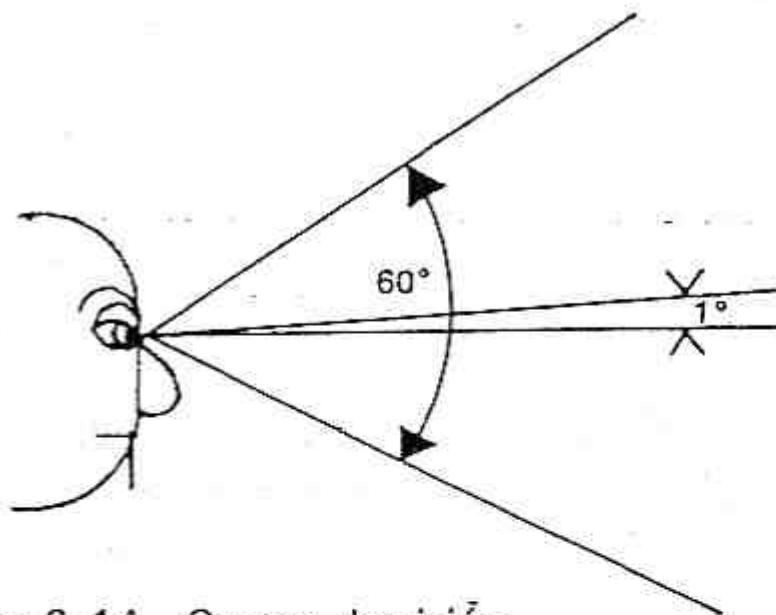
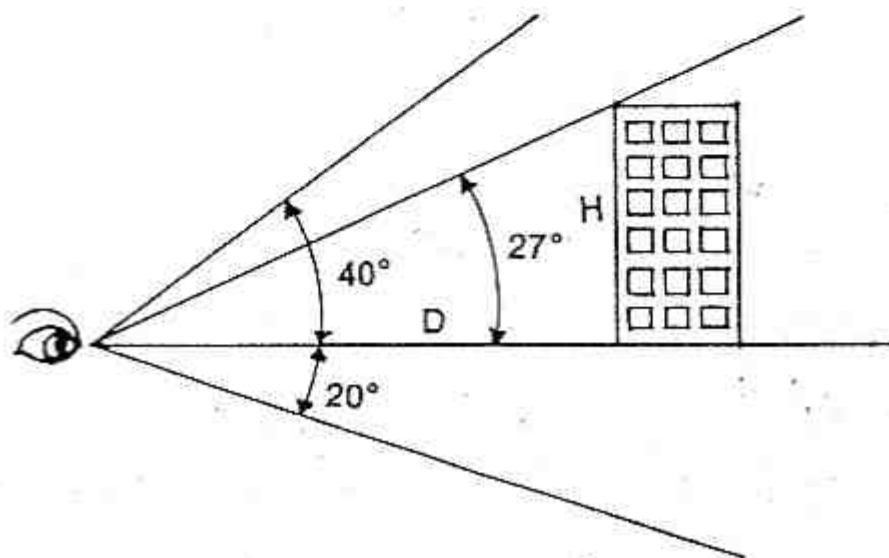
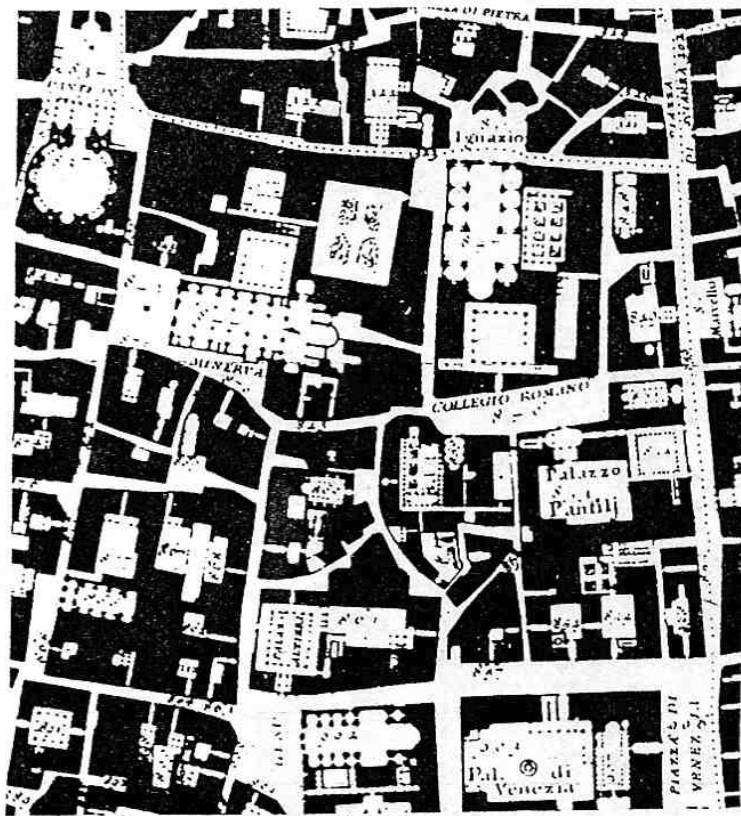
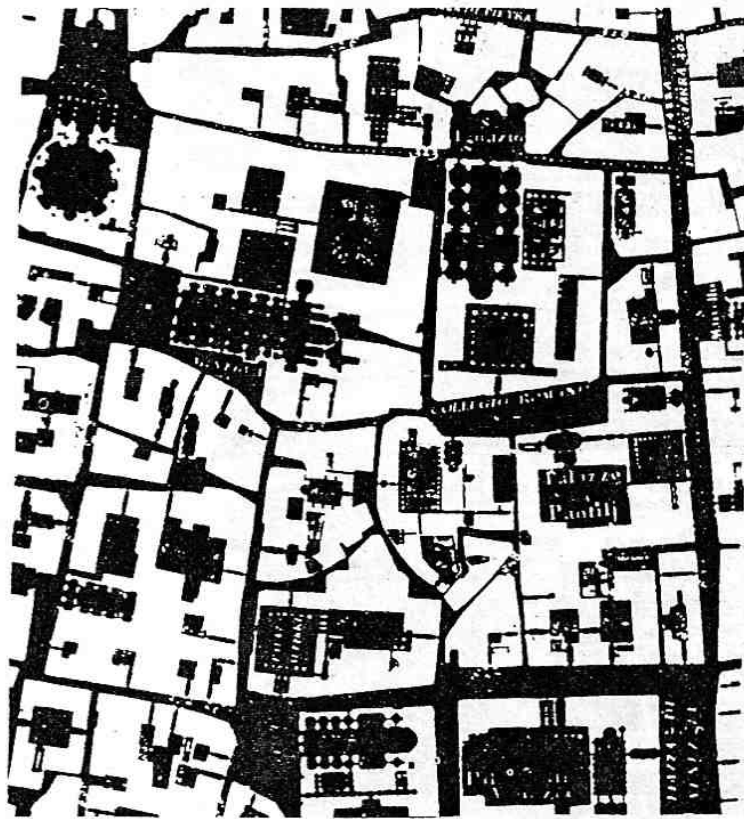

Fig. 2-1A. Campo de visión.



ORIENTAÇÃO



Espaços exteriores ordenados por **centralidades e áreas interior**

escala pequenas

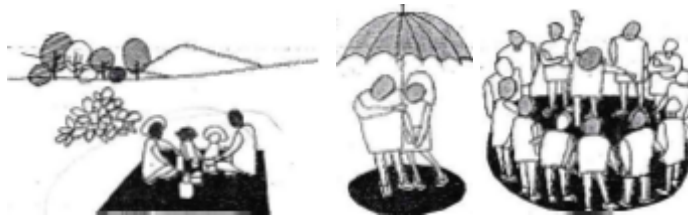

Sala vazia com uma cadeira



Escala médias:



GRANDE ESCALA

Pirâmides: Espaços por centro de massa



Parque olímpico de Komazawa

6.4. Áreas exteriores com continuidades

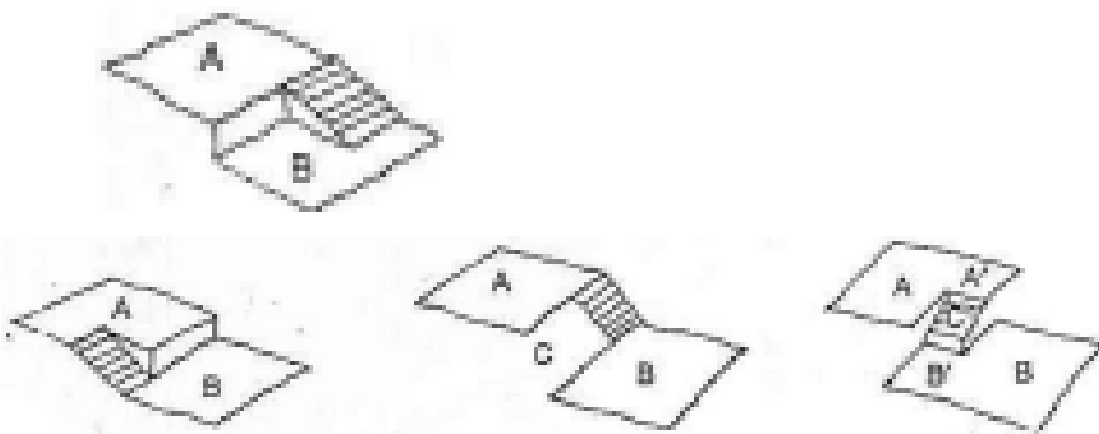
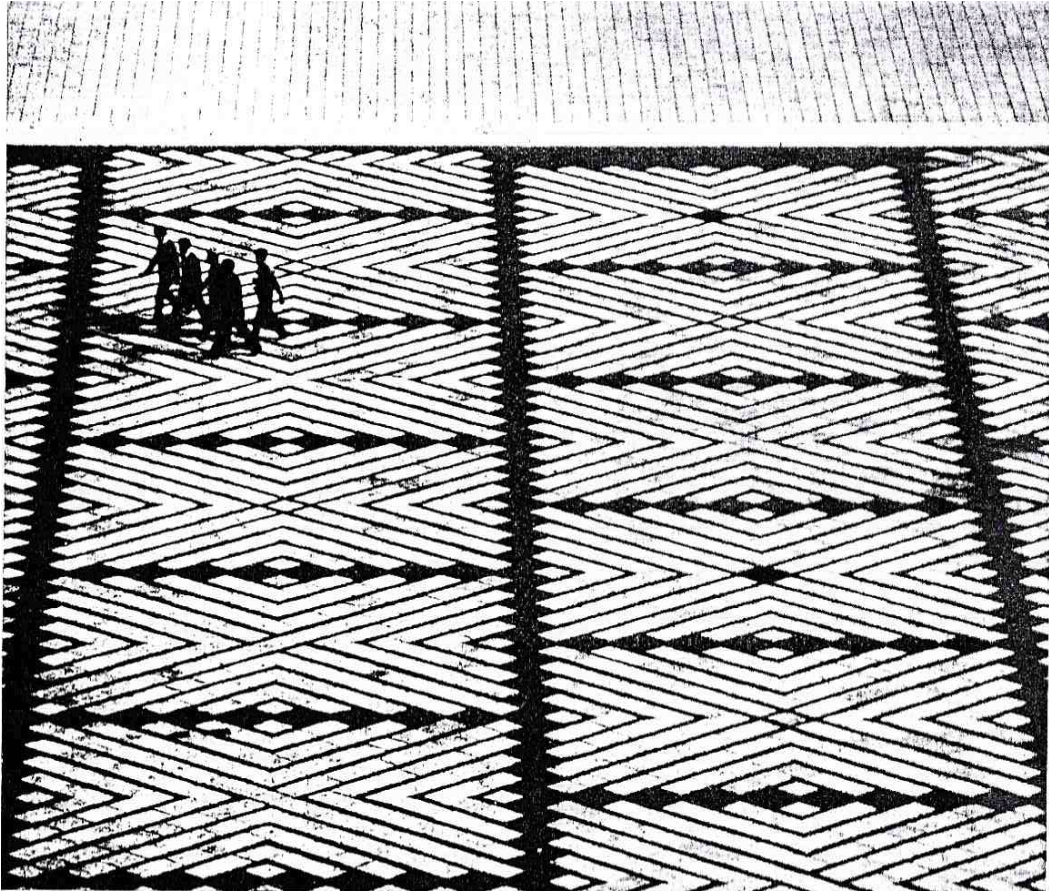

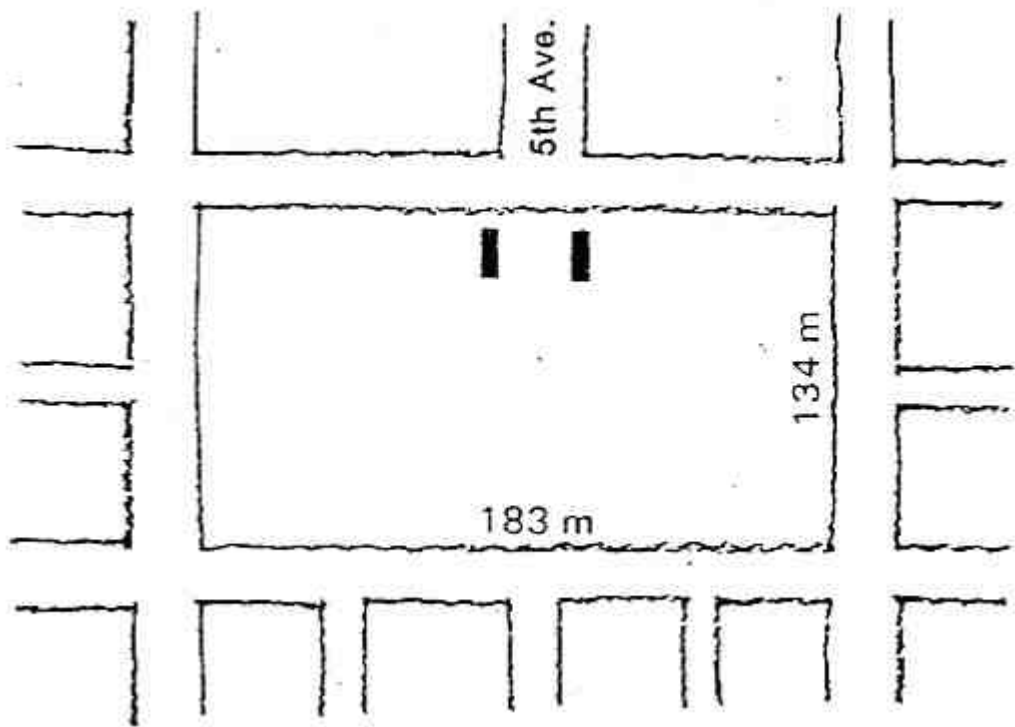
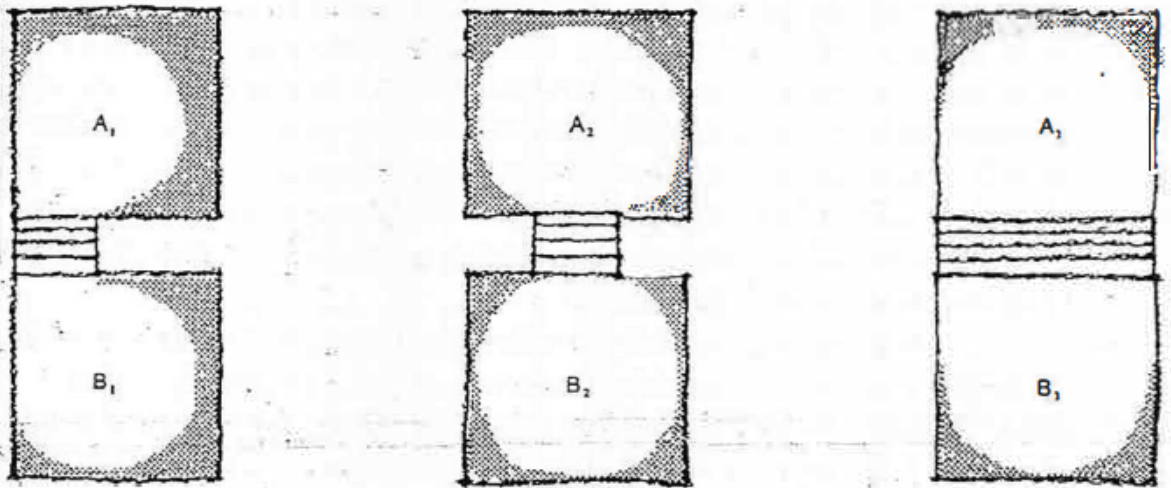

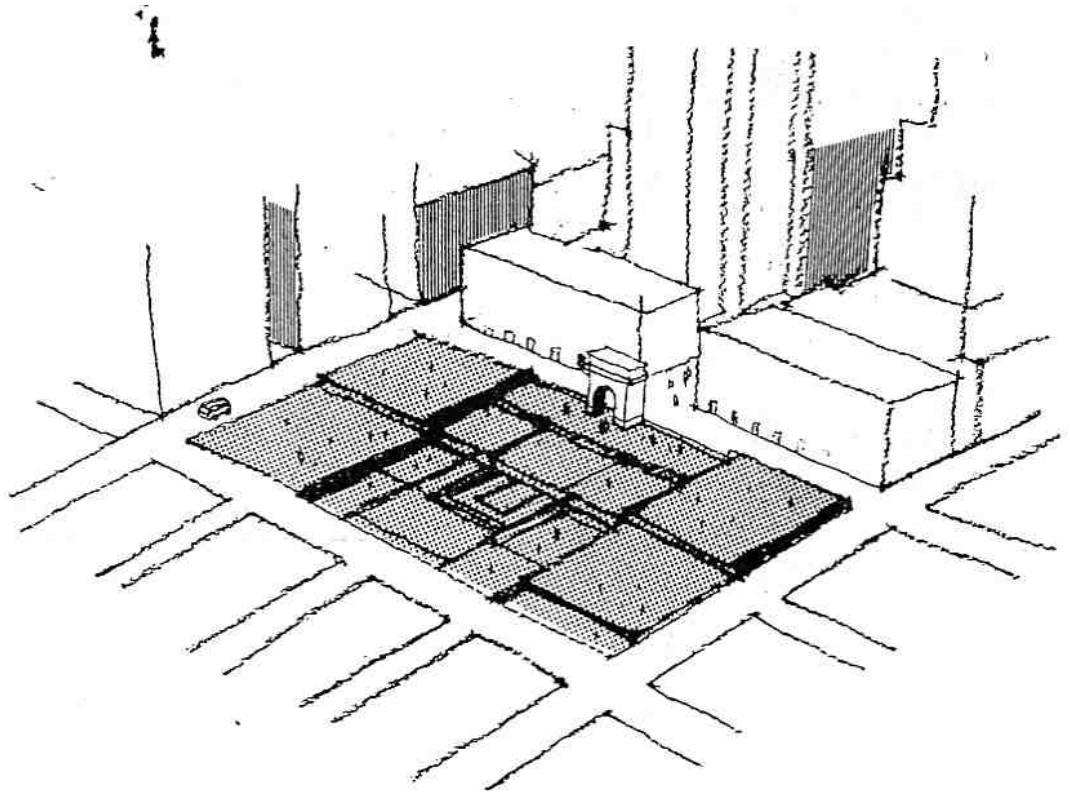

Washintong Square



130x180m

HIERARQUIA

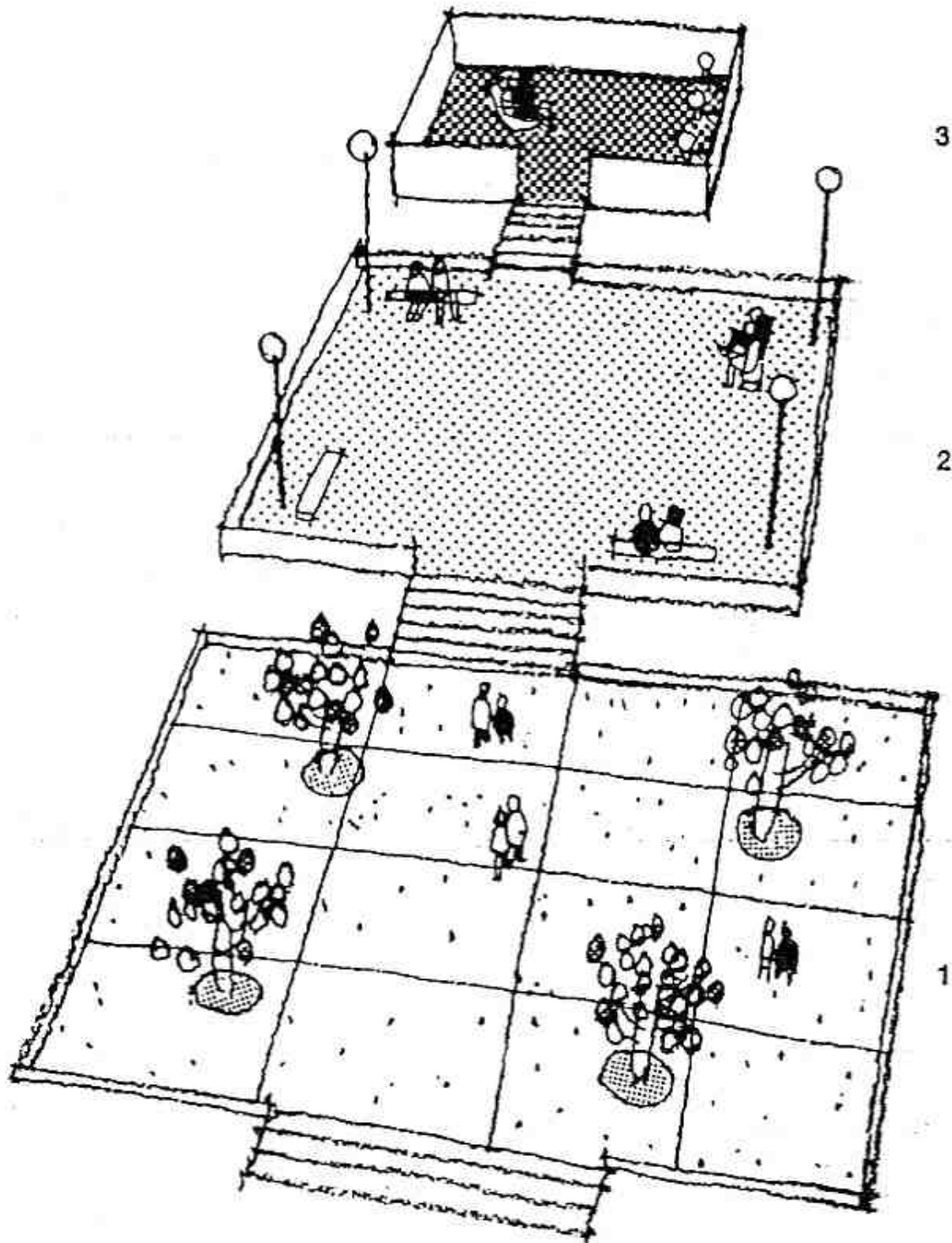

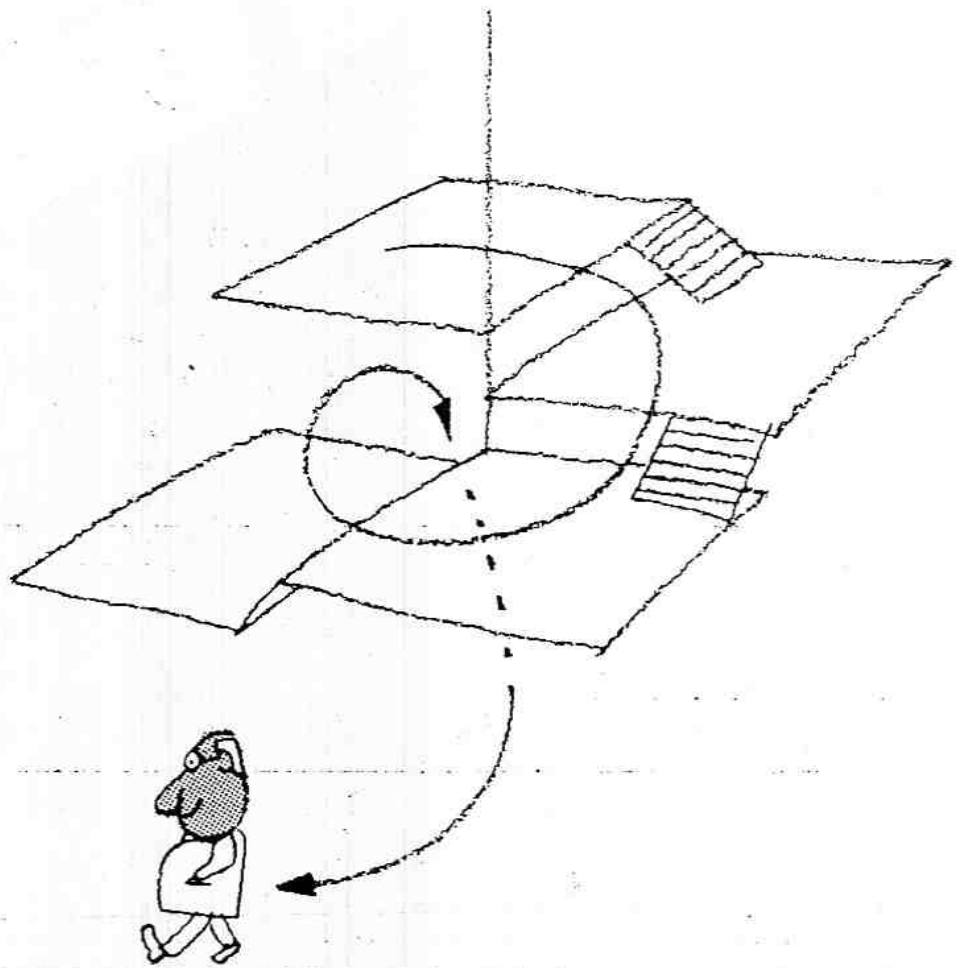

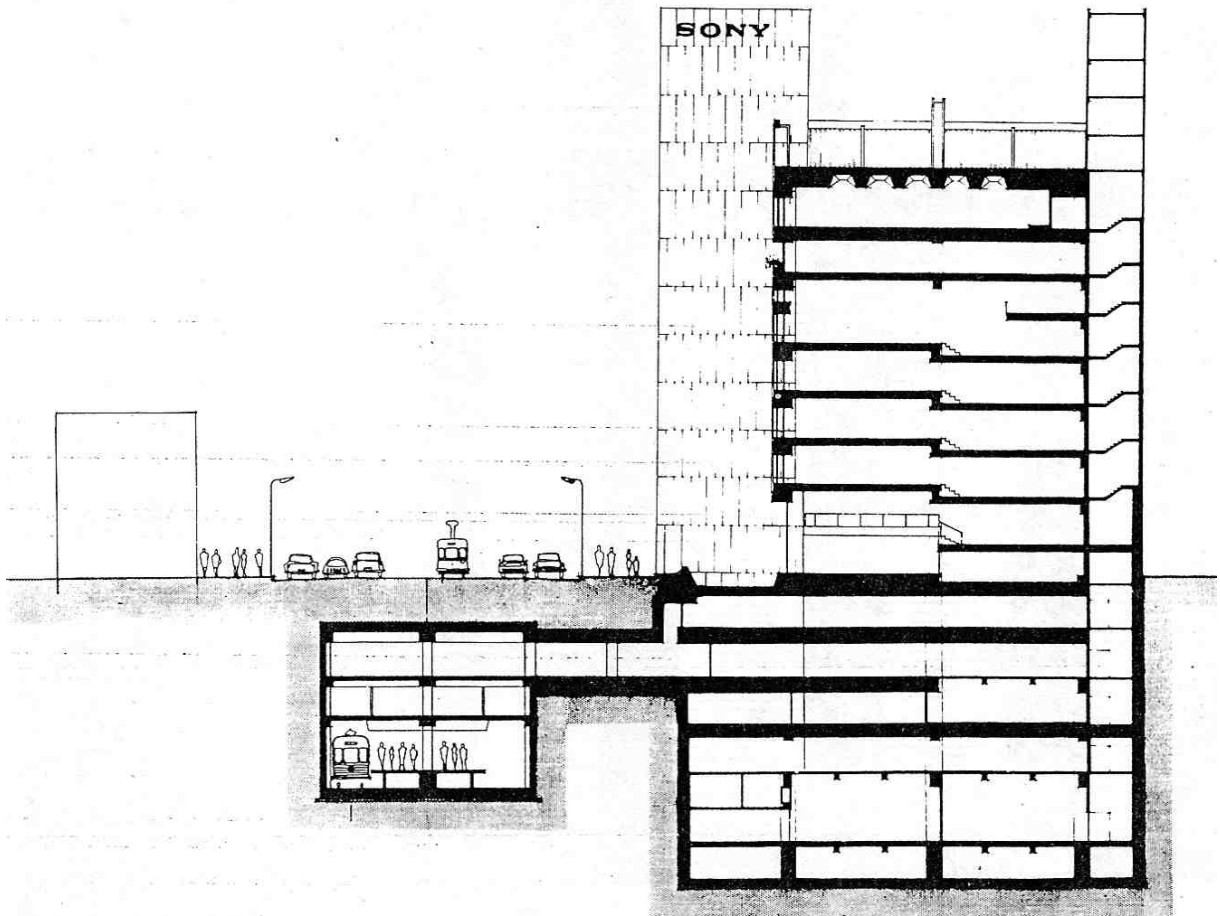

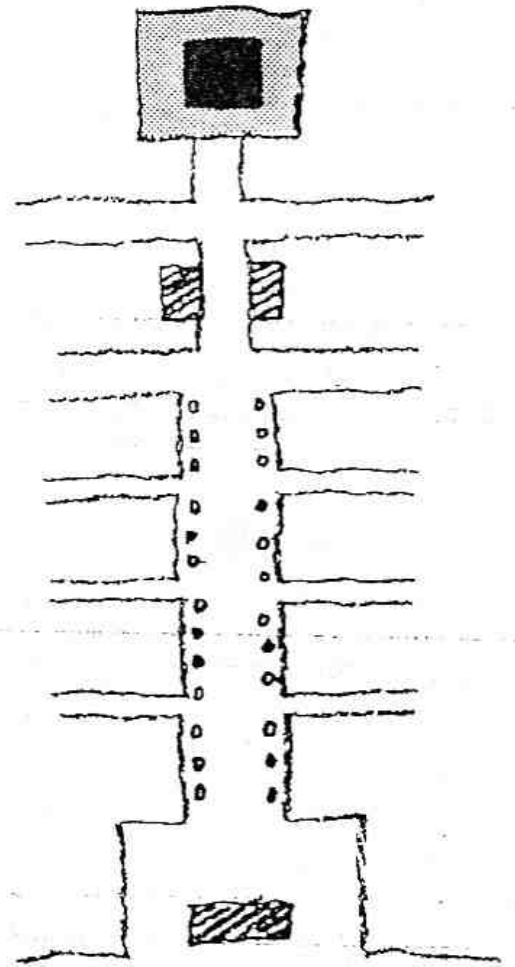
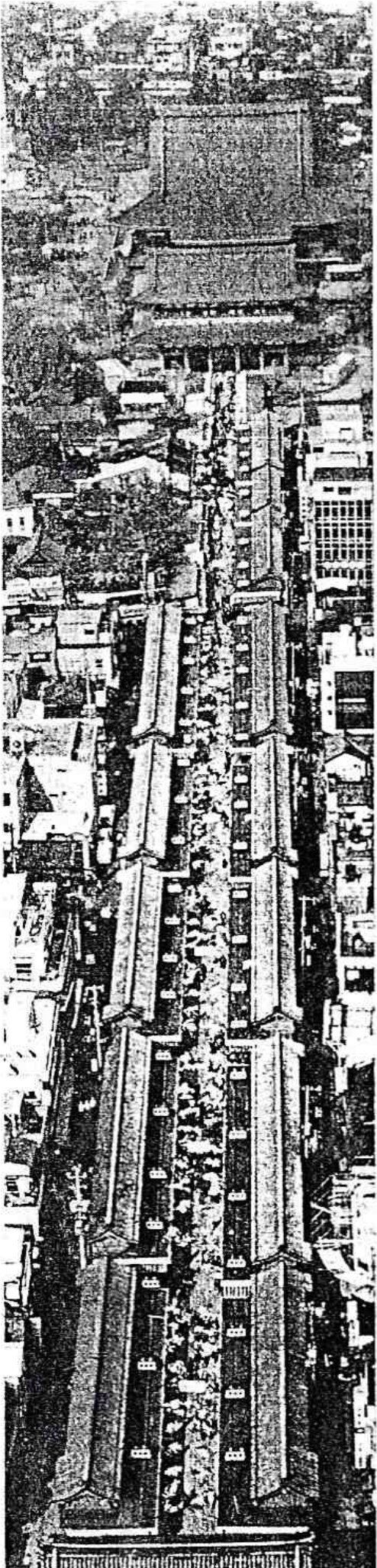

DINÂMICAS

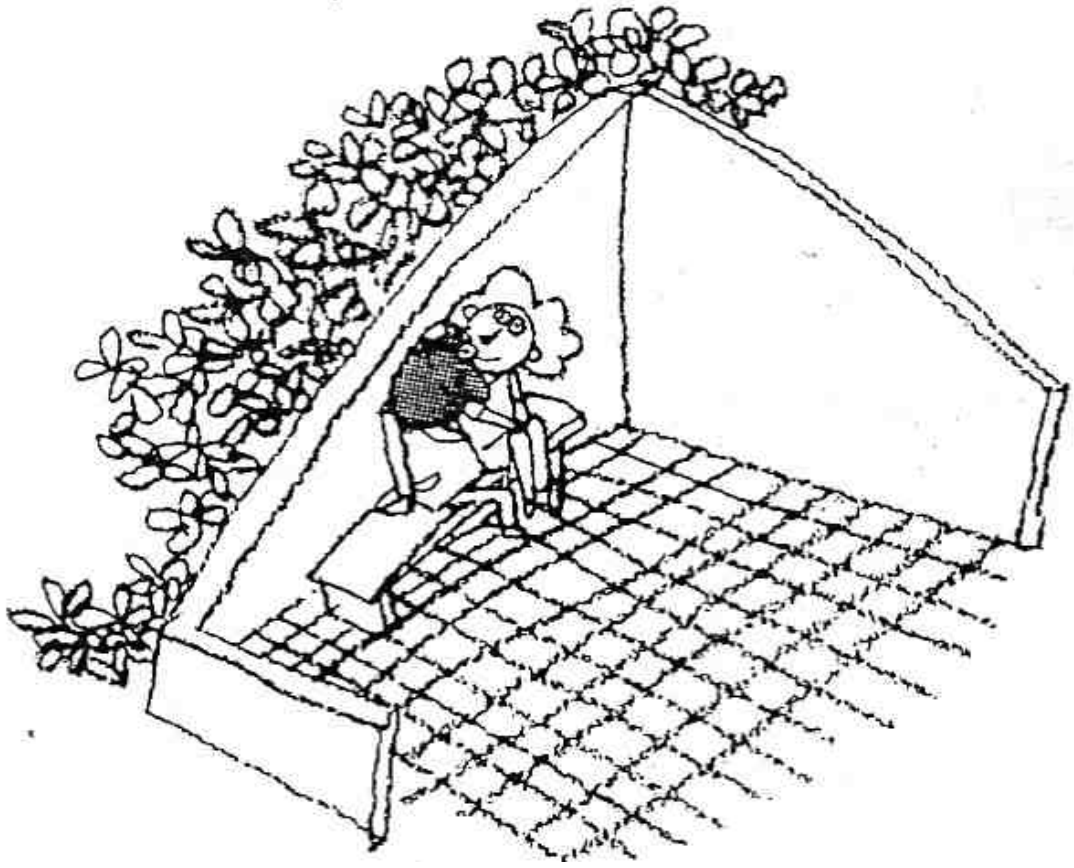

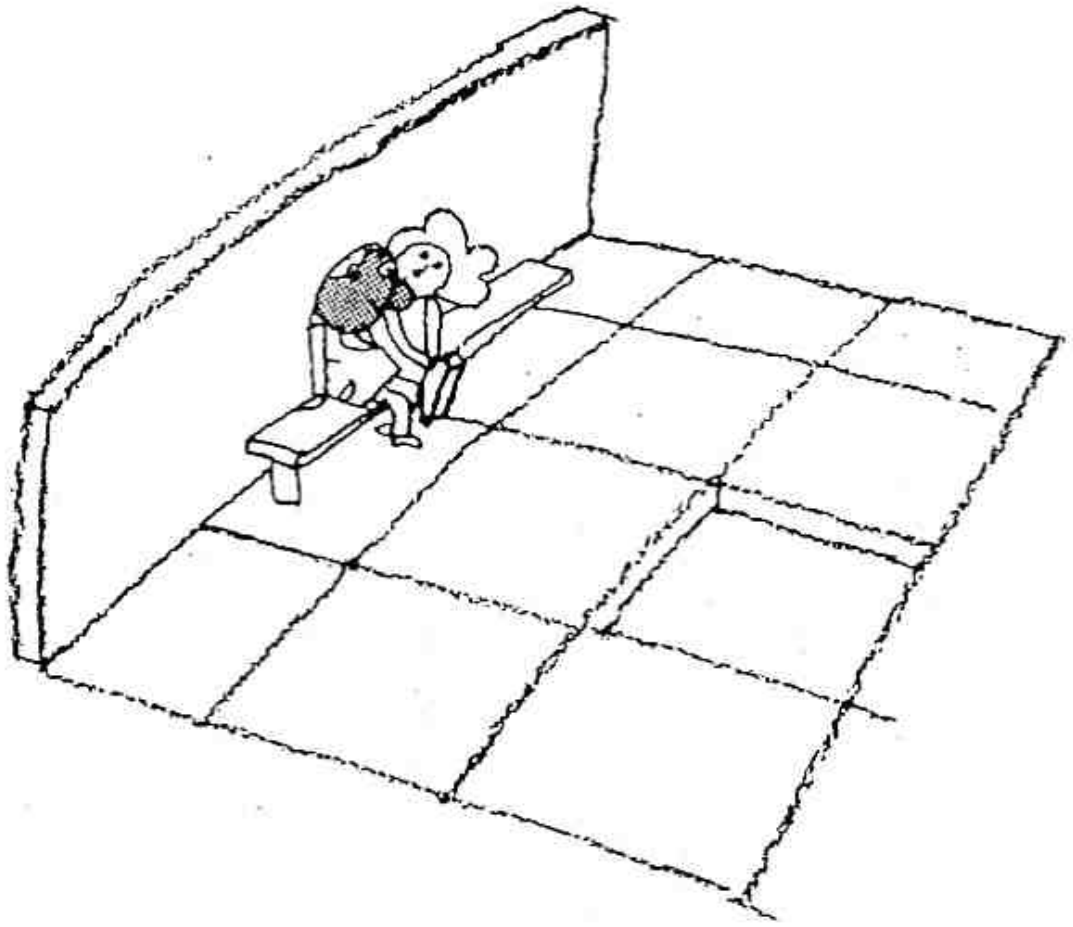

Hand-drawn illustration of a person sitting on a bench in a room with a tiled floor.

TEXTURAS

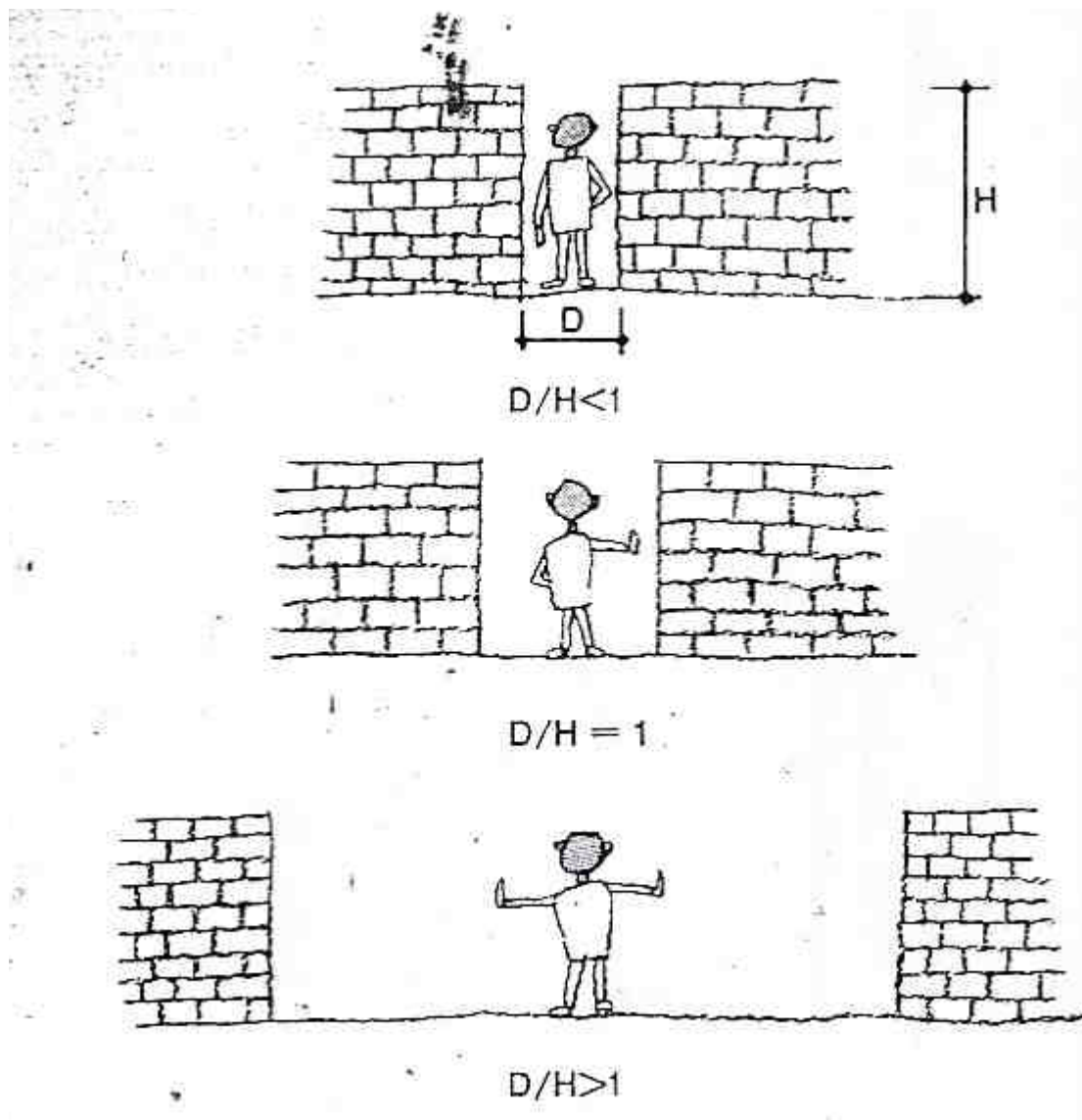

Espaço exterior positivo x Espaço exterior negativo



A

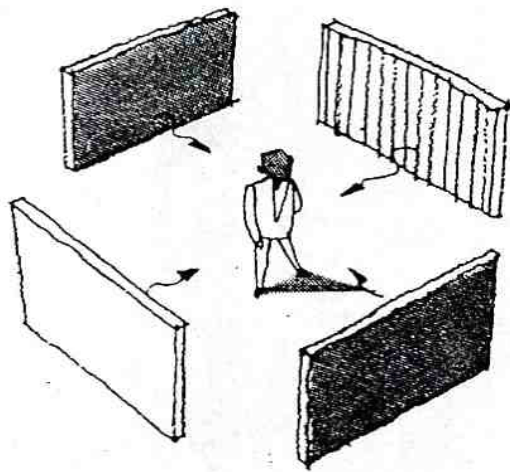

B

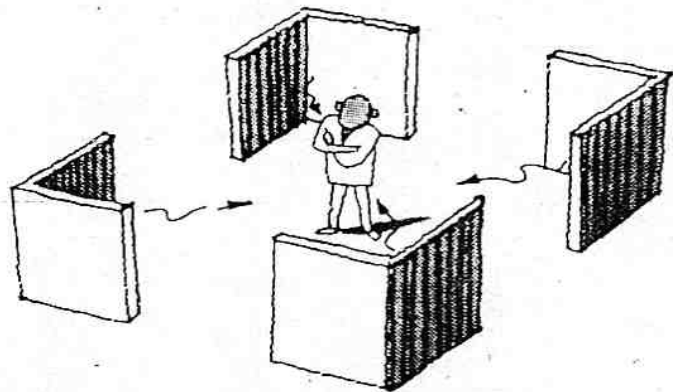

C

LINHAS GERAIS

Plano de Brasília

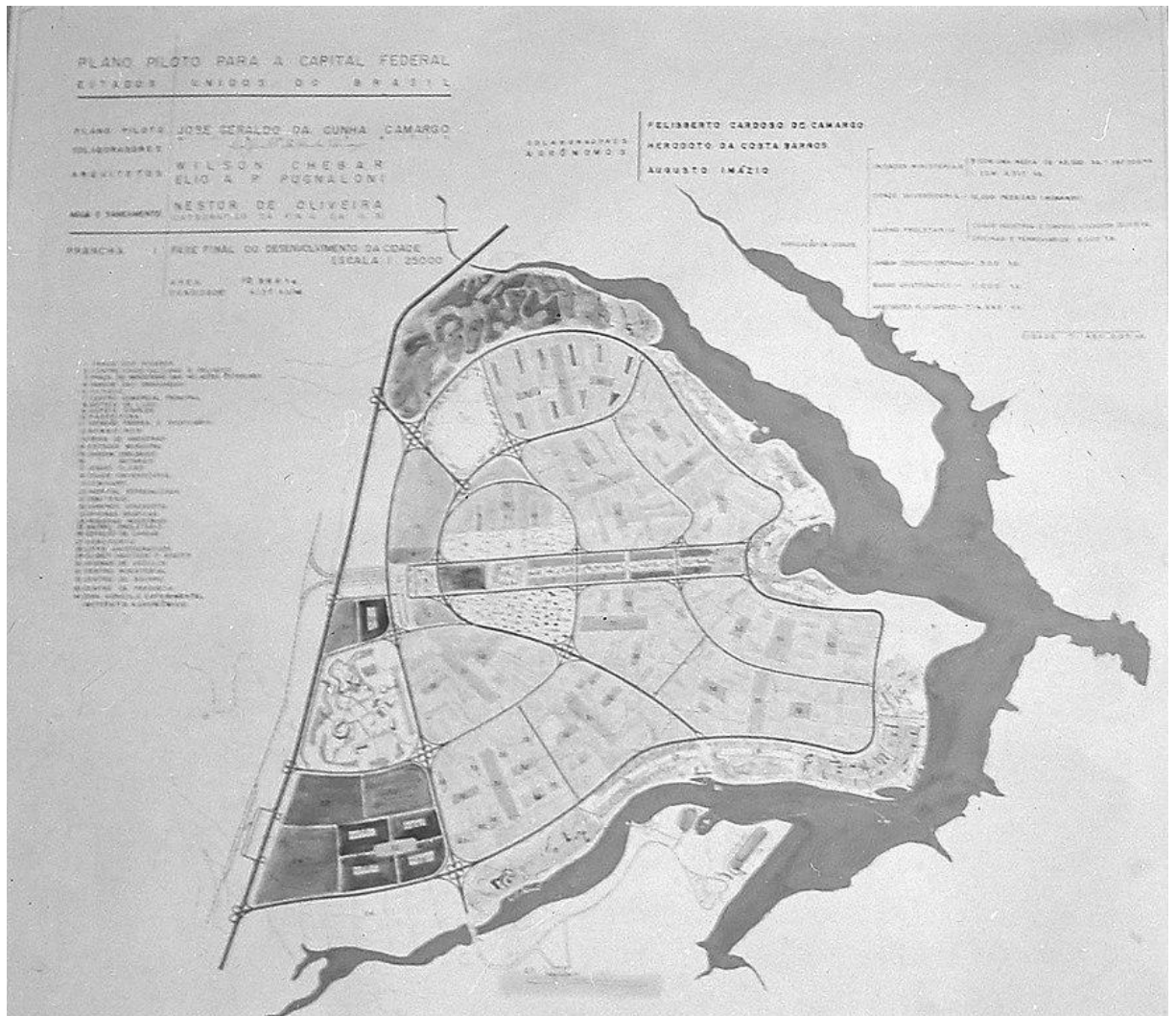

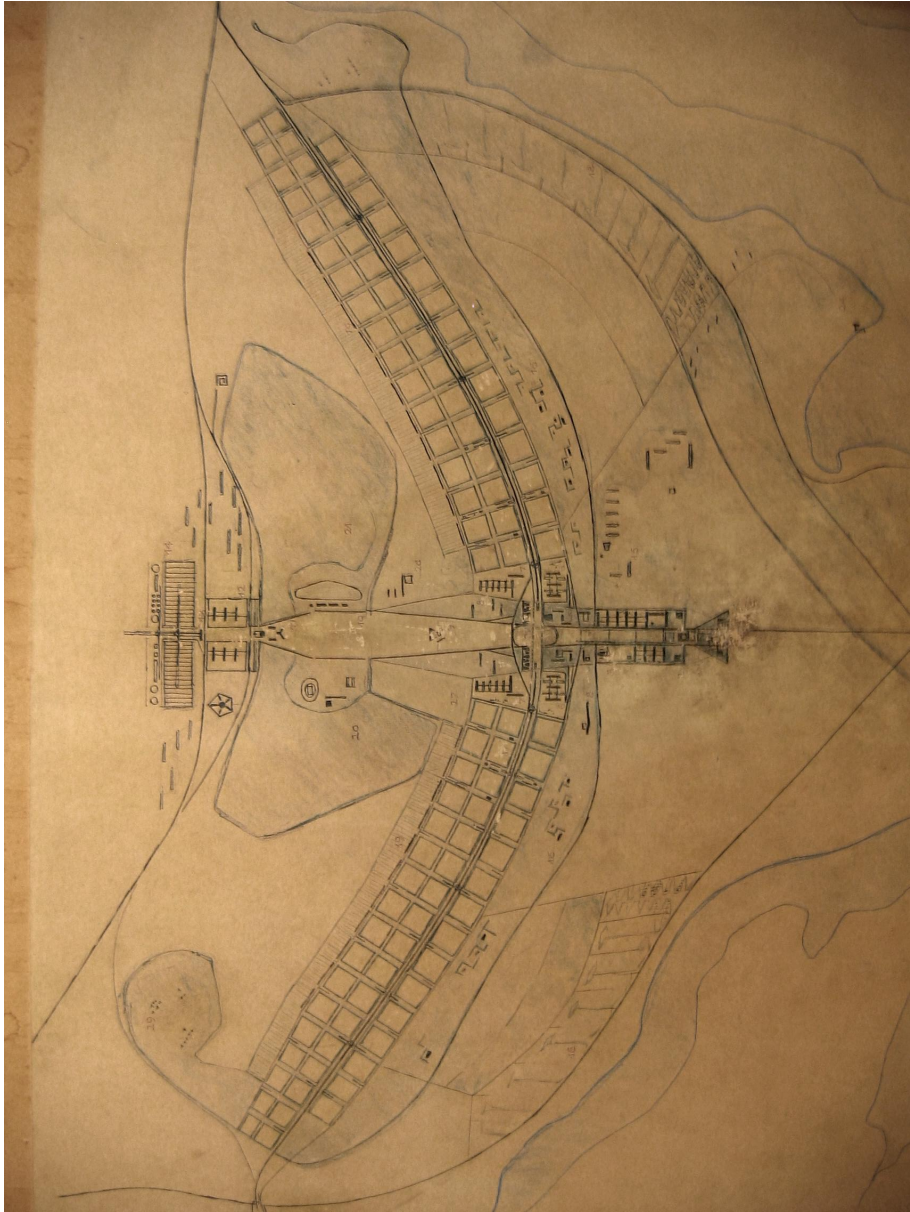

O espaço exterior malvado



MONUMENTALIDADE RUIM



City of London



Itinerância











obrigado.